

OPTION 4 - PREFERRED OPTION - ROUNDABOUT ALIGNMENT - HEALTH CENTRE RELOCATED

OPTION 4

Drwg. No.

OPTION 4

Job Title

NOTES

1. All dimensions are in millimetres unless otherwise stated.

KEY

- EXISTING CARRIAGEWAY
- PROPOSED CARRIAGEWAY RESURFACING
- HIGHWAY VERGE
- COLOURED SURFACING
- PROPOSED RETAINING WALLS
- PROPOSED FOOTWAY
- PROPOSED EMBANKMENT

Positive scheme element

Negative scheme element

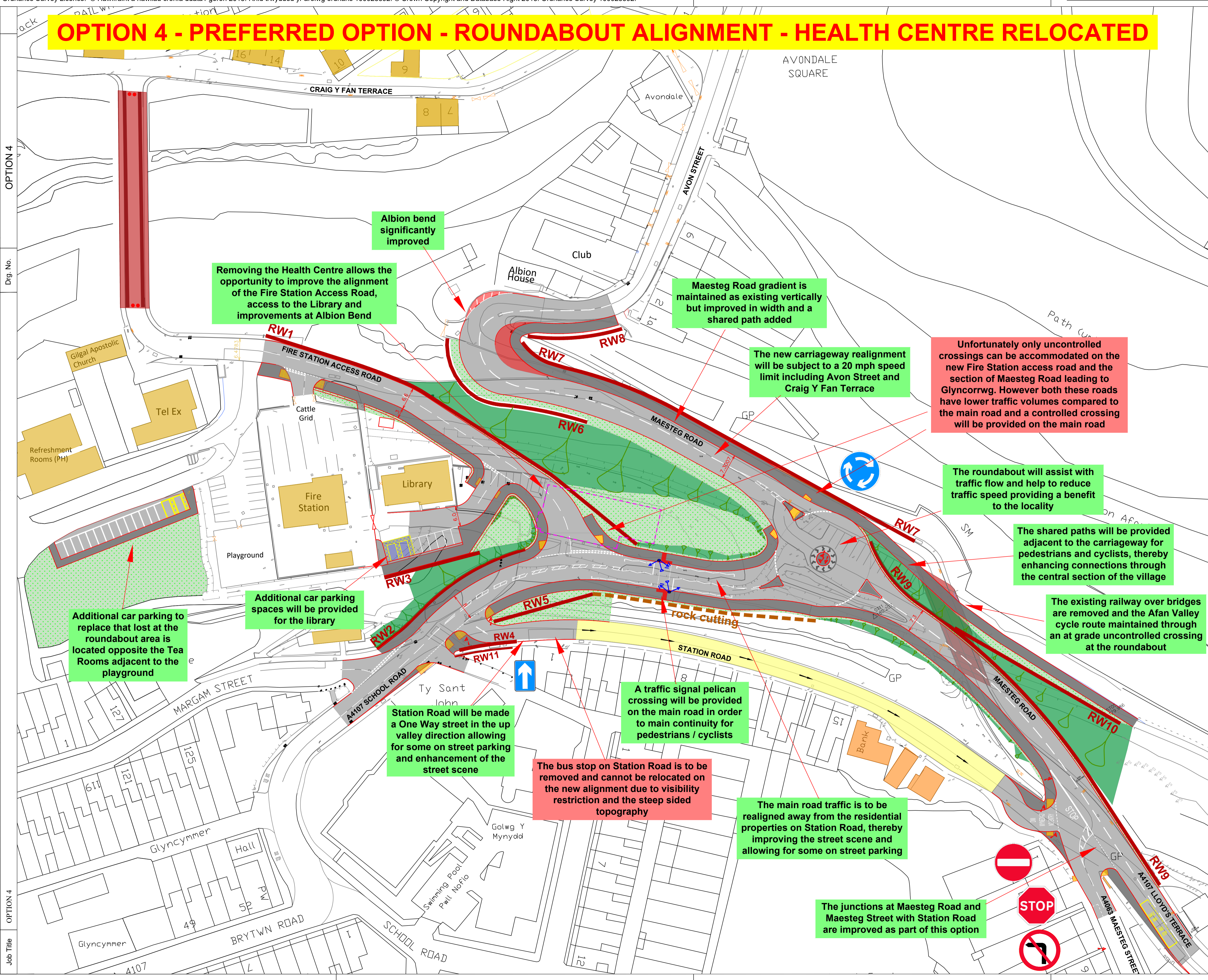

Removing the Health Centre allows the opportunity to improve the alignment of the Fire Station Access Road, access to the Library and improvements at Albion Bend

Albion bend significantly improved

Maesteg Road gradient is maintained as existing vertically but improved in width and a shared path added

The new carriageway realignment will be subject to a 20 mph speed limit including Avon Street and Craig Y Fan Terrace

Unfortunately only uncontrolled crossings can be accommodated on the new Fire Station access road and the section of Maesteg Road leading to Glynccorwg. However both these roads have lower traffic volumes compared to the main road and a controlled crossing will be provided on the main road

The roundabout will assist with traffic flow and help to reduce traffic speed providing a benefit to the locality

The shared paths will be provided adjacent to the carriageway for pedestrians and cyclists, thereby enhancing connections through the central section of the village

The existing railway over bridges are removed and the Afan Valley cycle route maintained through an at grade uncontrolled crossing at the roundabout

Additional car parking to replace that lost at the roundabout area is located opposite the Tea Rooms adjacent to the playground

Additional car parking spaces will be provided for the library

Station Road will be made a One Way street in the up valley direction allowing for some on street parking and enhancement of the street scene

A traffic signal pelican crossing will be provided on the main road in order to main continuity for pedestrians / cyclists

The bus stop on Station Road is to be removed and cannot be relocated on the new alignment due to visibility restriction and the steep sided topography

The main road traffic is to be realigned away from the residential properties on Station Road, thereby improving the street scene and allowing for some on street parking

The junctions at Maesteg Road and Maesteg Street with Station Road are improved as part of this option

Rev	Details	Dr	Ch	Ap	Date

Client	
--------	--

Cyngor Castell-nedd Port Talbot
Neath Port Talbot Council

ENGINEERING AND TRANSPORT

NICOLA PEARCE BSC (Hons), Dip TP, MRTPI
DIRECTOR OF ENVIRONMENT AND REGENERATION
THE QUAYS, BRUNEL WAY
BAGLAN ENERGY PARK
NEATH SA11 2GG

Job Title
C20910 CYMMER CARRIAGEWAY RE-ALIGNMENT
OPTION 4: PREFERRED ROUNDABOUT OPTION WITH HEALTH CENTRE RELOCATED

File No.	Financial Code No.	26/007500/B054/266305			
Drawn	AAI	Checked	MCB	Approved	HIH
Date	MAY '21	Date	MAY '21	Date	MAY '21
Scales	1:500	Status	PRELIM		
Drawing No.	OPTION 4				